

Plan 20-0010-003-1V - Ind2 : Huisserie métal parement élargi -TI8 PE EXP

Pose en tableau

Gamme Porte feu EI60 et EI60 Acoustique

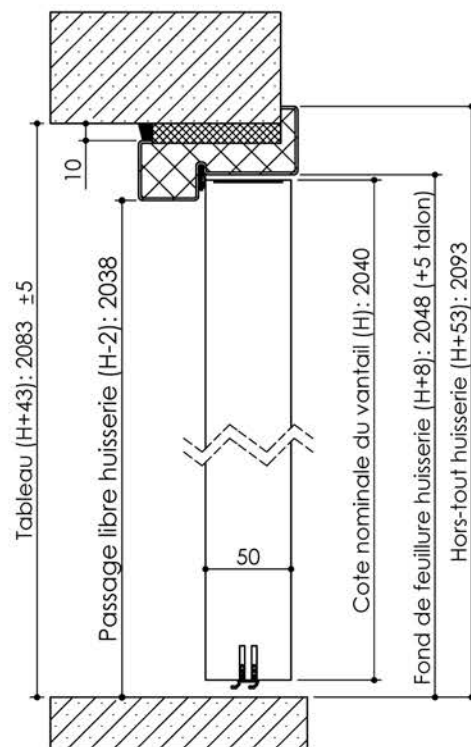
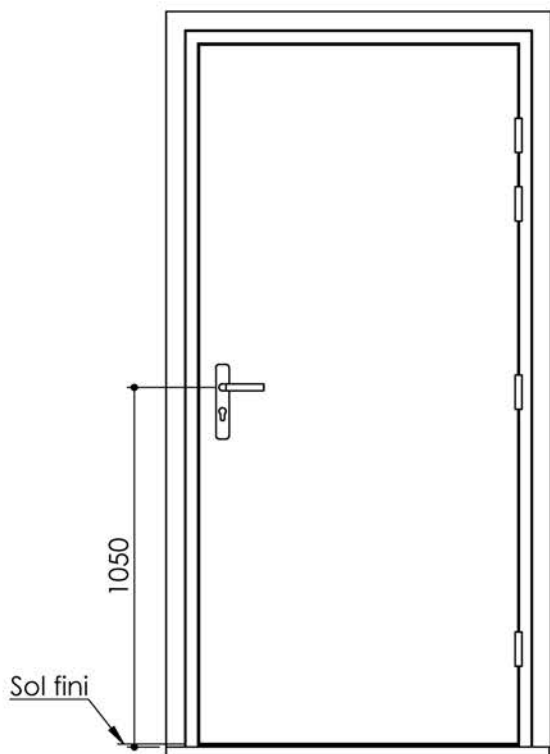

Huisserie isophonique

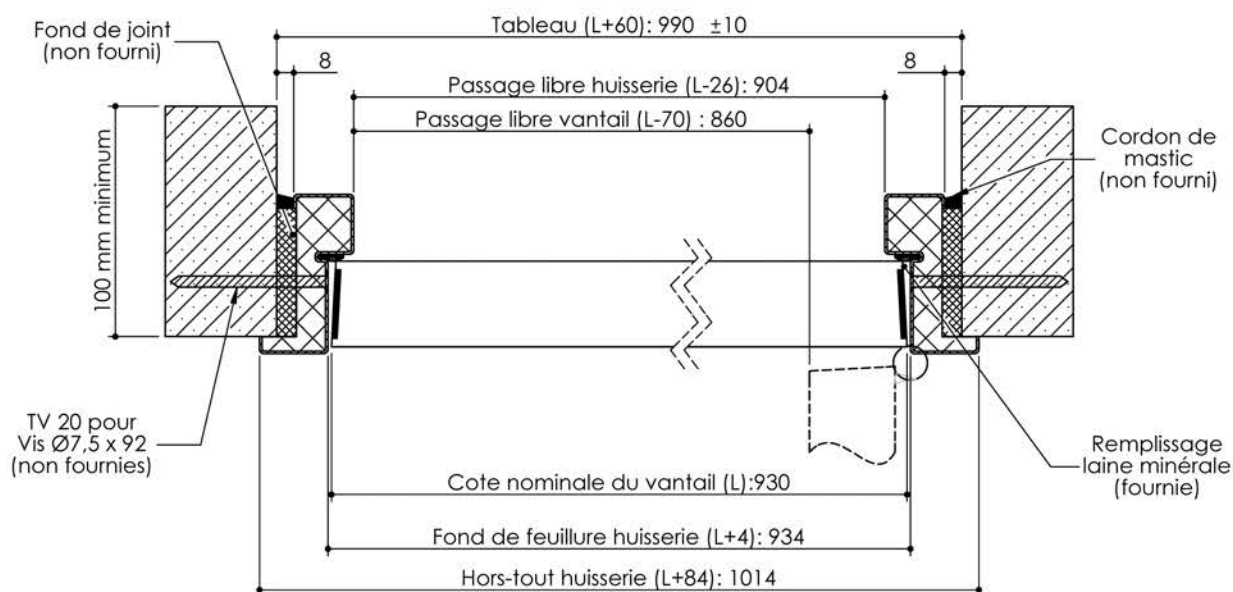
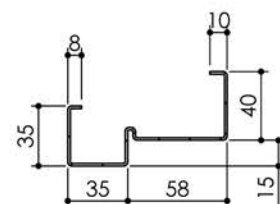
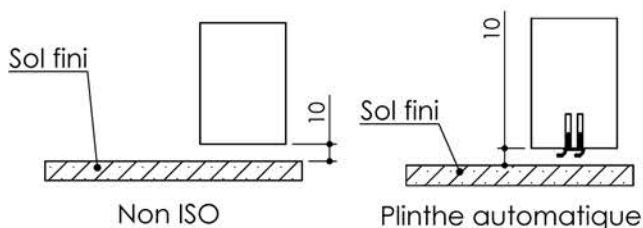

20-0010-003-1V 08/02/2021

Plan non contractuel, Keyor se réserve le droit de modifier ce plan pour des raisons industrielles

Plan 20-0010-004-2V-A - Ind2 : Huisserie métal parement élargi - TI8 PE EXP

Pose en tableau

Gamme Porte feu EI60 et EI60 Acoustique (feuilure centrale de 15).

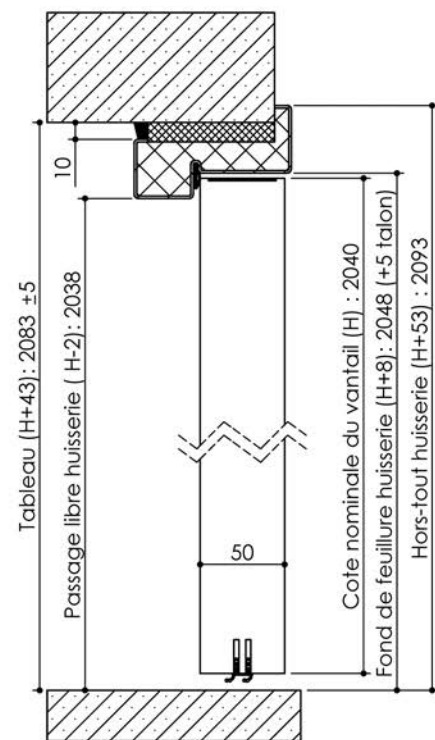
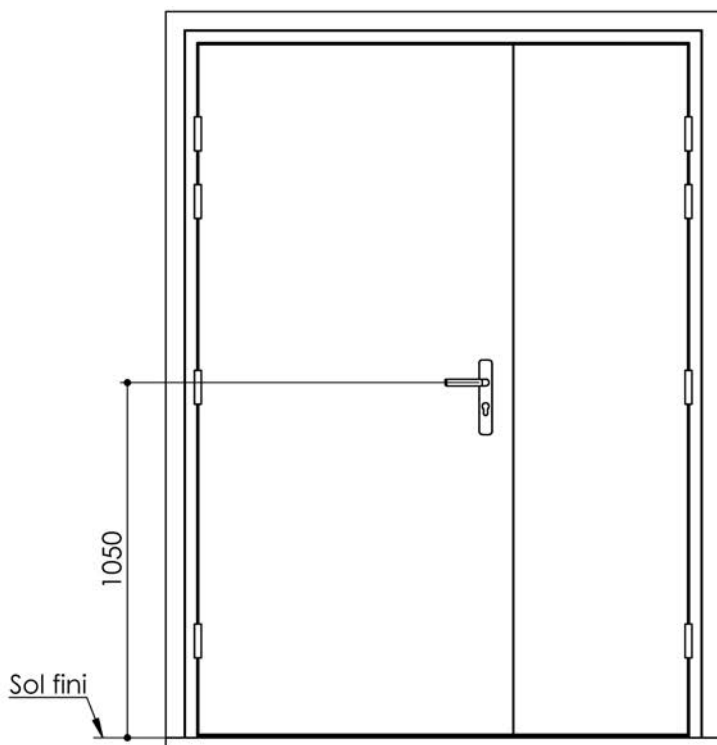

Variantes bas de porte

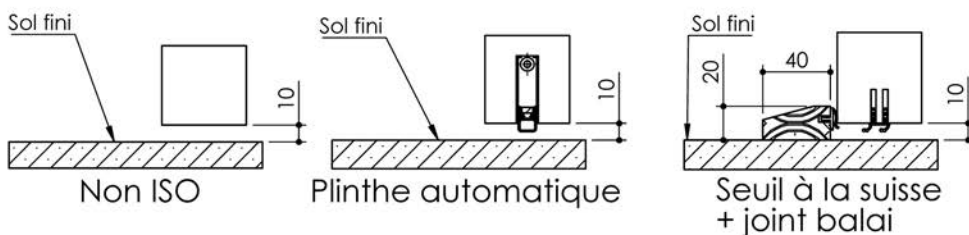

Huisserie isophonique

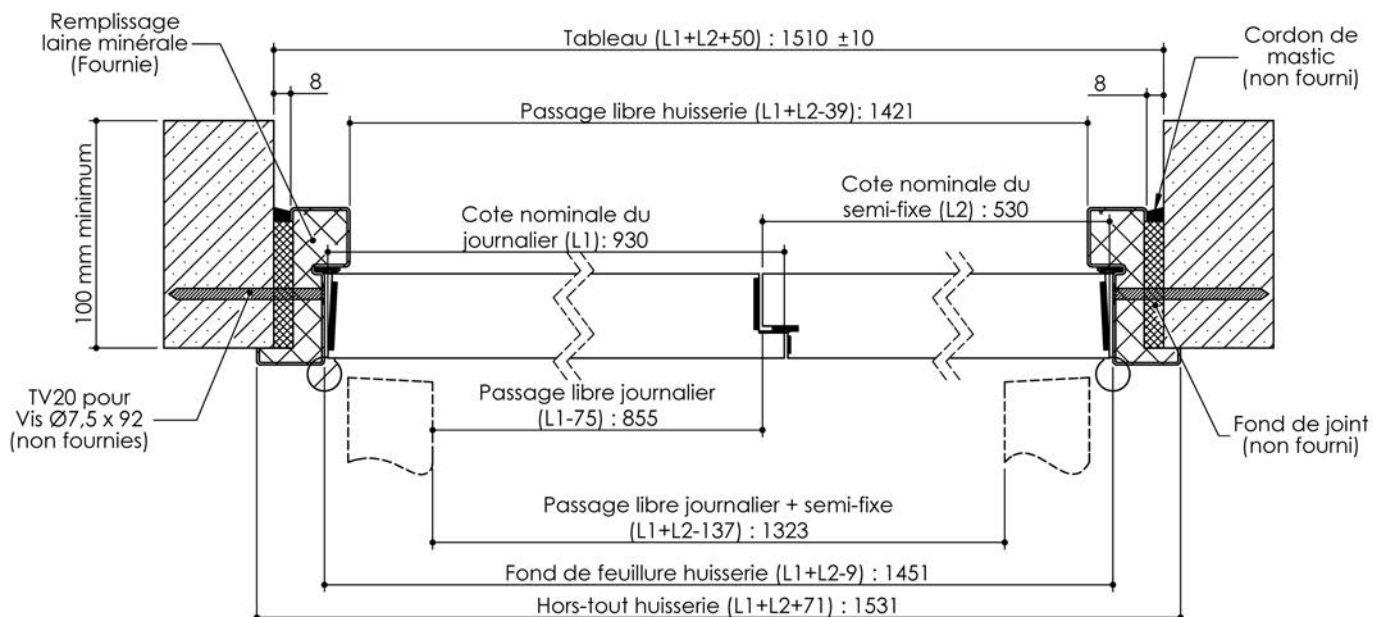
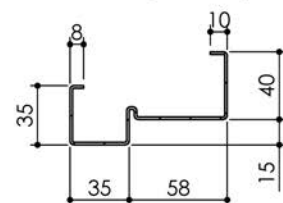

20-0010-004-2V-A 08/02/2021

Plan 20-0010-005-2V-B - Ind2 : Huisserie métal parement élargi - TI8 PE EXP

Pose en tableau

Gamme Porte feu EI60 et EI60 Acoustique (feuilure centrale de 25).



Largeur standard en 2V : 935 + 535

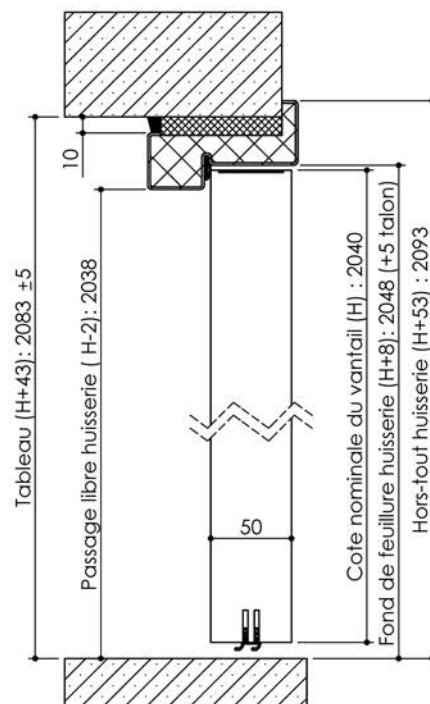
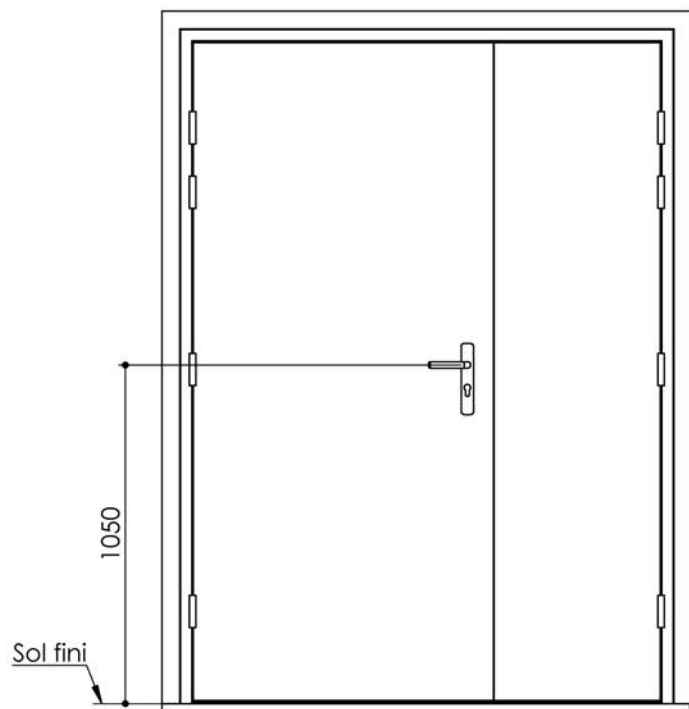

Variantes bas de porte

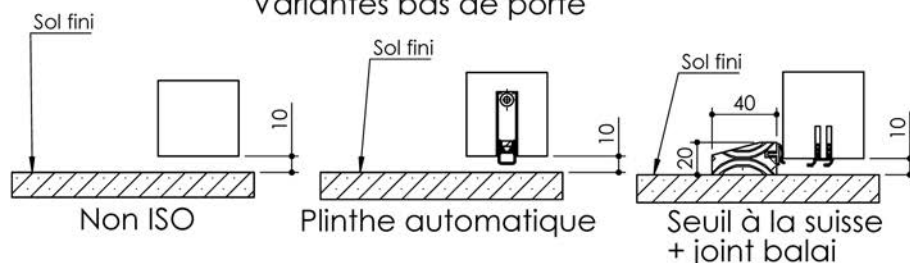

Huisserie

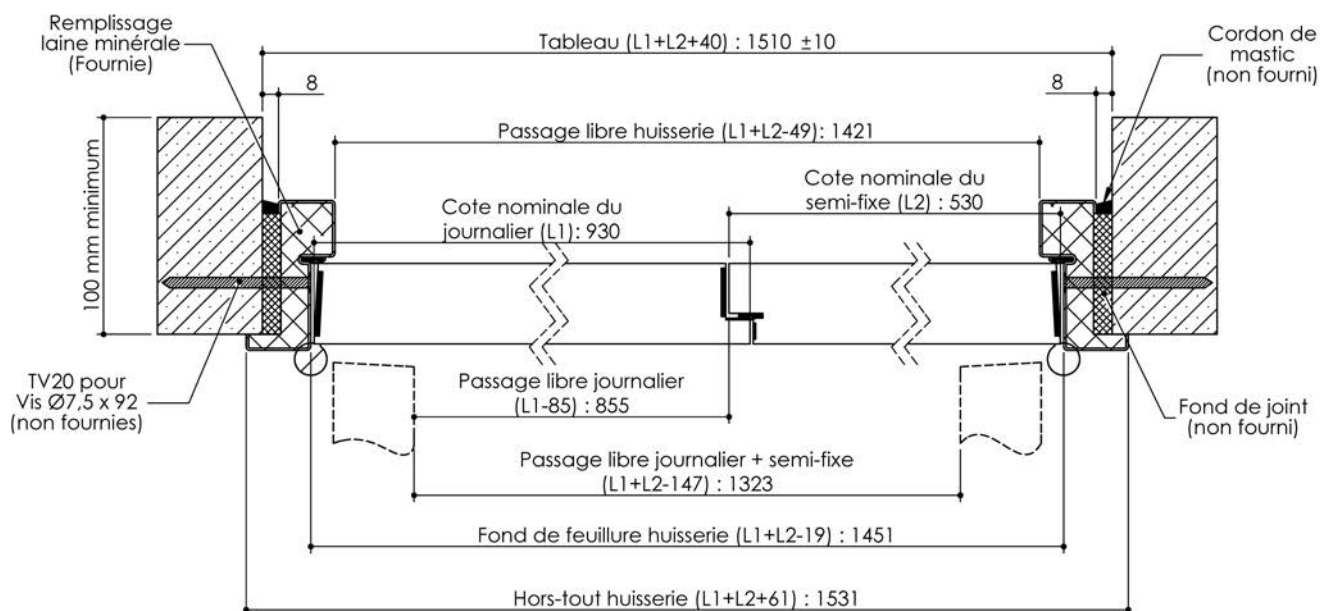
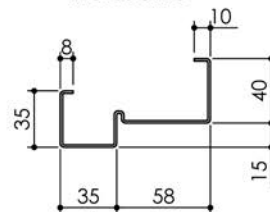

20-0010-005-2V-B 08/02/2021

Plan non contractuel, Keyor se réserve le droit de modifier ce plan pour des raisons industrielles