

# Plan PB-220-2V-B \_ Ind5 : Bati métal - Pose scellée

Gamme Porte feu EI60 STD (SUPRAFEU EI60 feuillure centrale de 25).

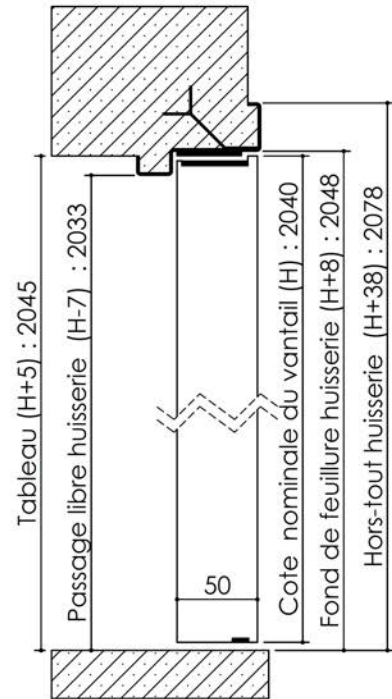

Largeur standard en 2V : 935 + 535

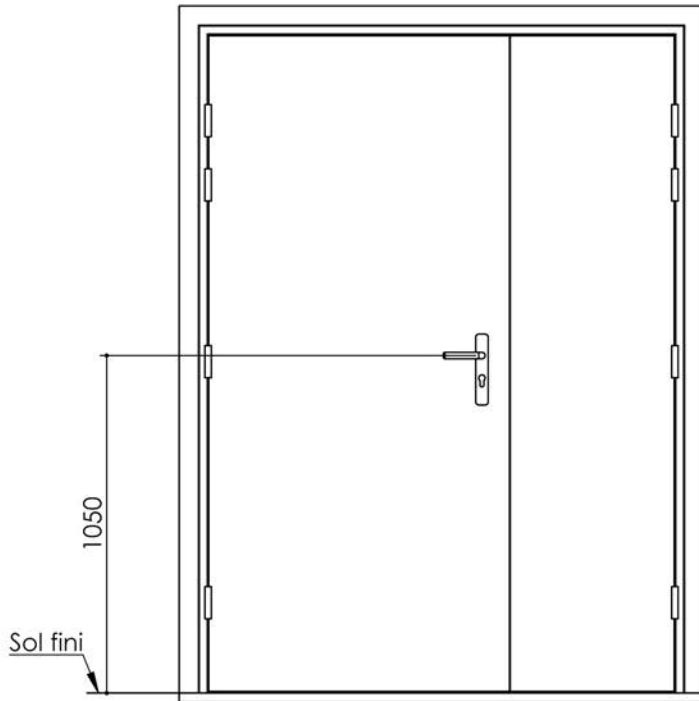

Variante bas de porte

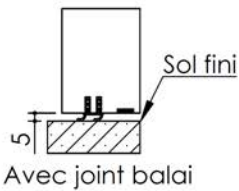

Détail de feuillure centrale de 25

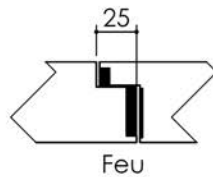

Huisserie non isophonique

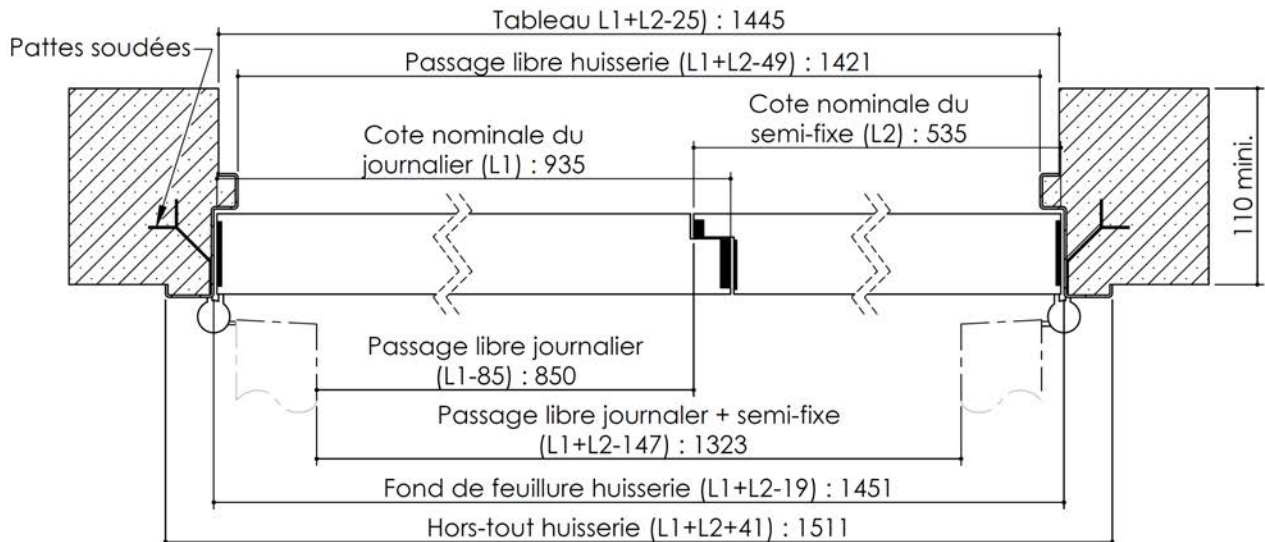
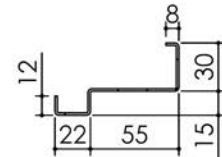

PB-220-2V -B 01/07/2019

Plan non contractuel, Keyor se réserve le droit de modifier ce plan pour des raisons industrielles