

# Plan PB-223-1V \_ Ind7 : Huisserie bois - Pose scellée

Gamme Porte feu EI60

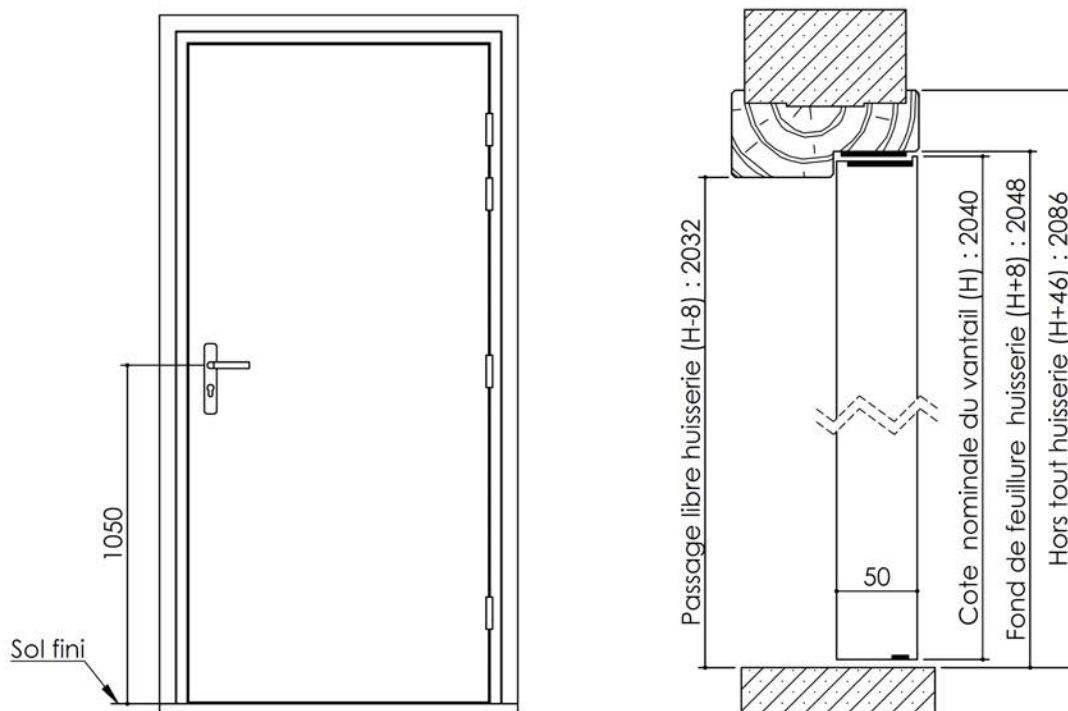

Variante bas de porte

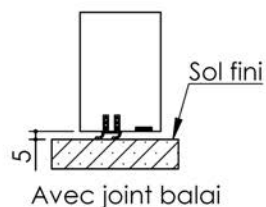

Huisserie non isophonique

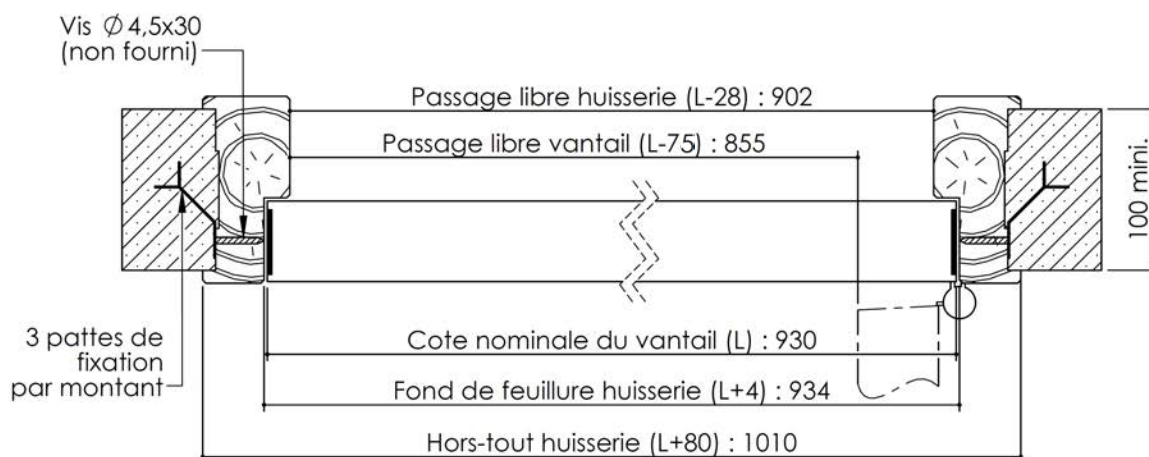
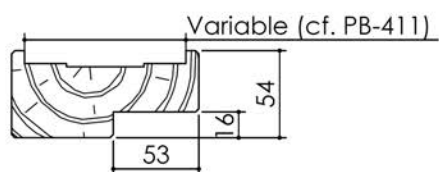

PB-223-1V 01/07/2019

# Plan PB-223-2V-A \_ Ind7 : Huisserie bois - Pose scellée

Gamme Porte feu EI60 GD (SUPRAFEU GD feuillure centrale de 15).

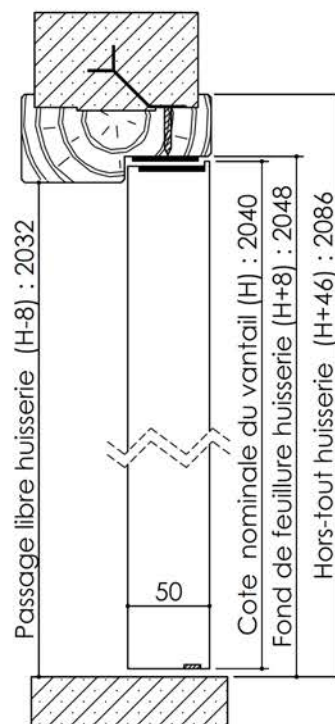
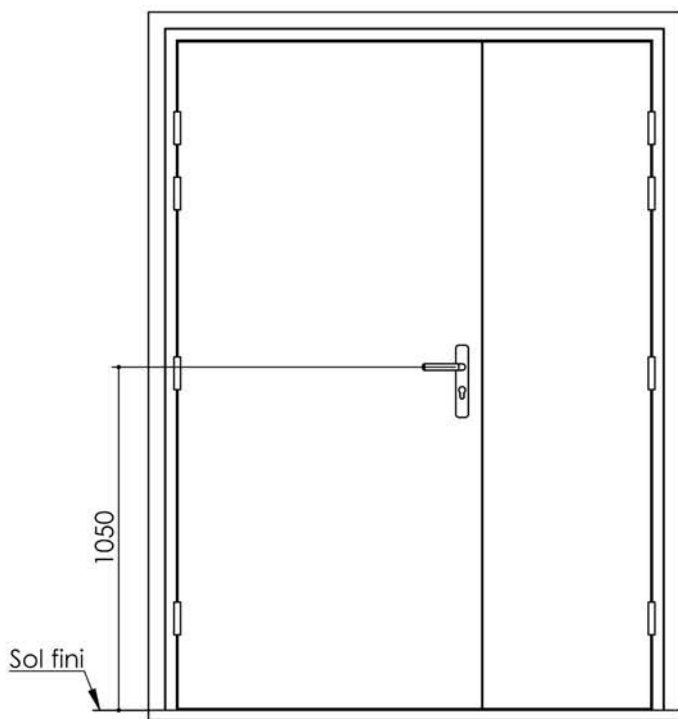

Variante bas de porte

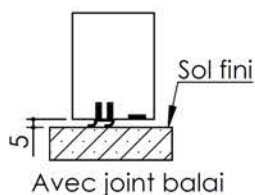

Détail de feuillure centrale de 15

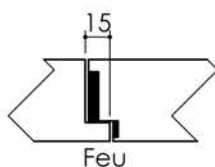

Huisserie non isophonique

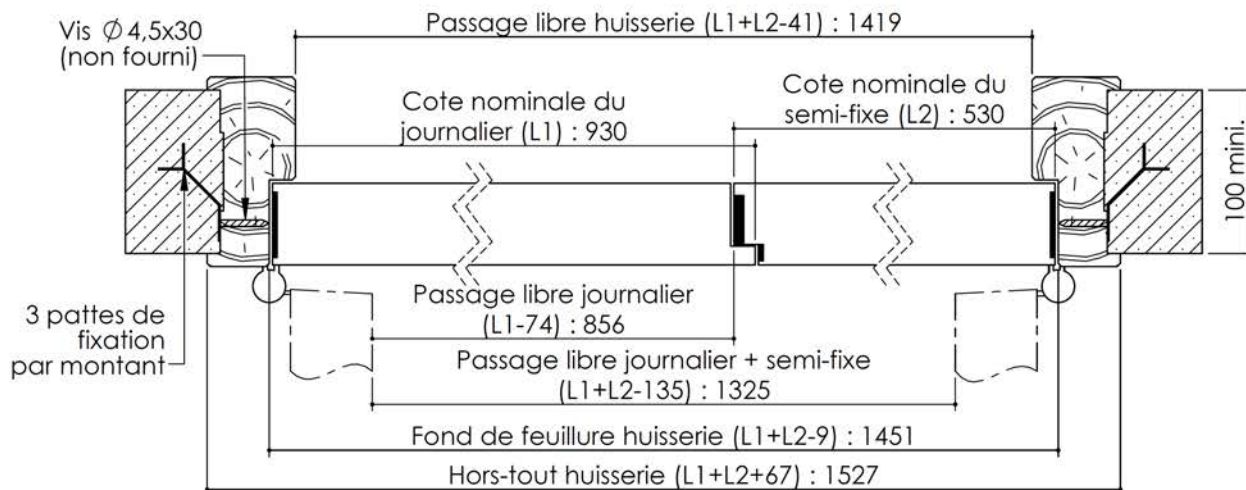
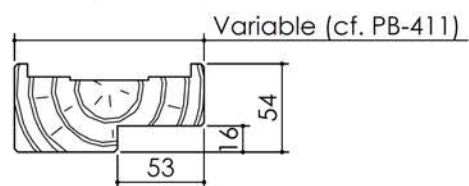

**KEYOR**

PB-223-2V-A 01/07/2019

Plan non contractuel, Keyor se réserve le droit de modifier ce plan pour des raisons industrielles

# Plan PB-223-2V-B \_ Ind7 : Huisserie bois - Pose scellée

Gamme Porte feu EI60 STD (SUPRAFEU EI60 feuillure centrale de 25).



**Largeur standard en 2V : 935 + 535**

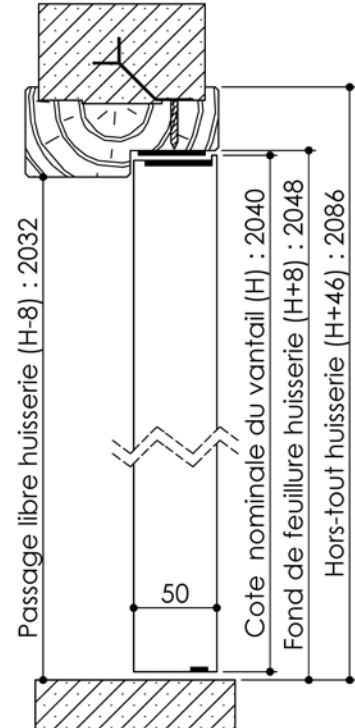
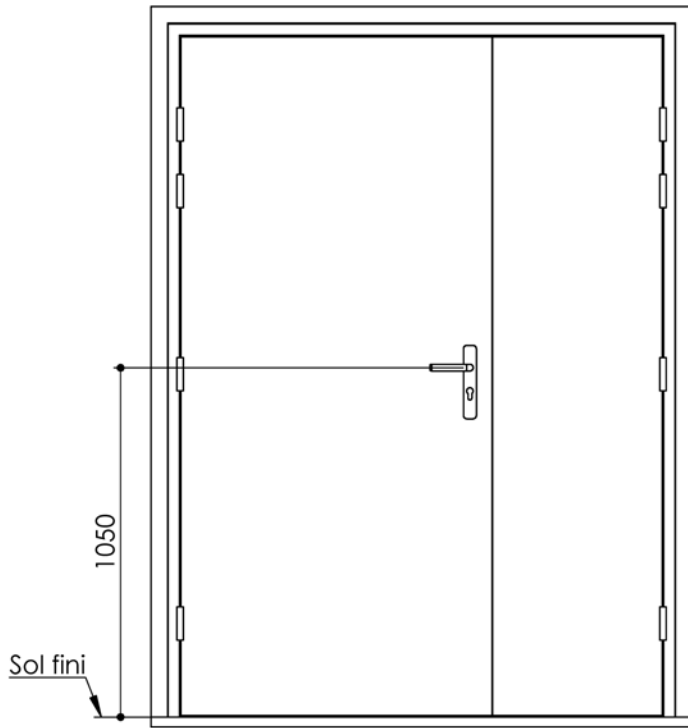

Variante bas de porte

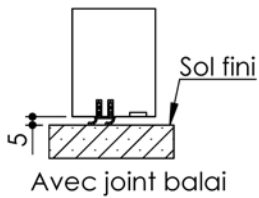

Détail de feuillure centrale de 25

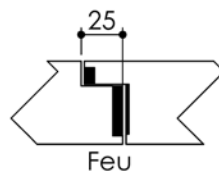

Huisserie non isophonique

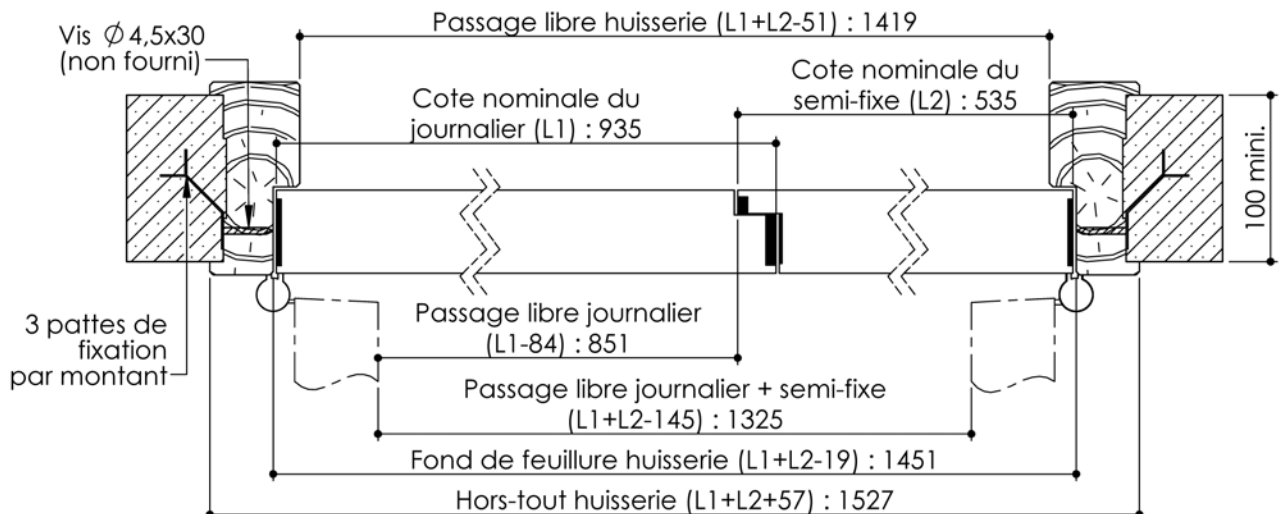
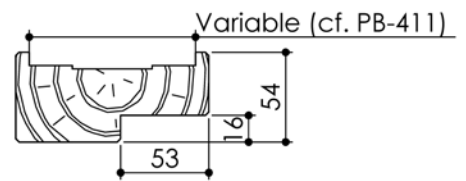

PB-223-2V-B 01/07/2019

Plan non contractuel, Keyor se réserve le droit de modifier ce plan pour des raisons industrielles