

Plan PB-7-1V _ Ind3 : Huisserie bois - Pose en tableau

Gamme Porte de Communication

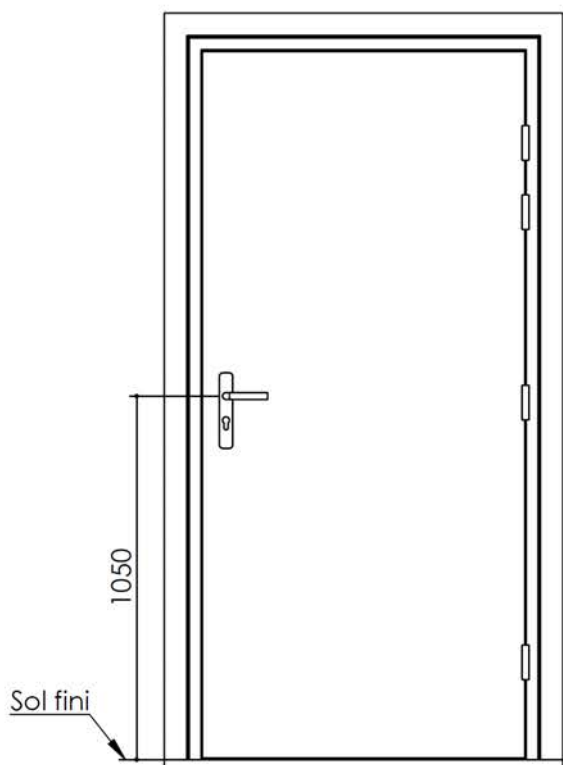

Huisserie non isophonique

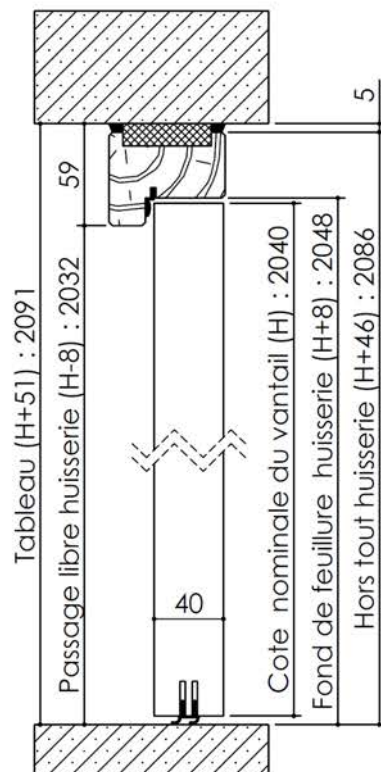
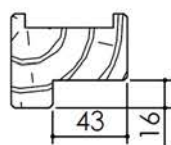

Huisserie isophonique

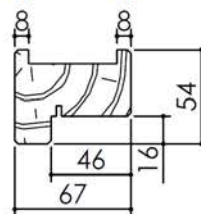

Variantes bas de porte

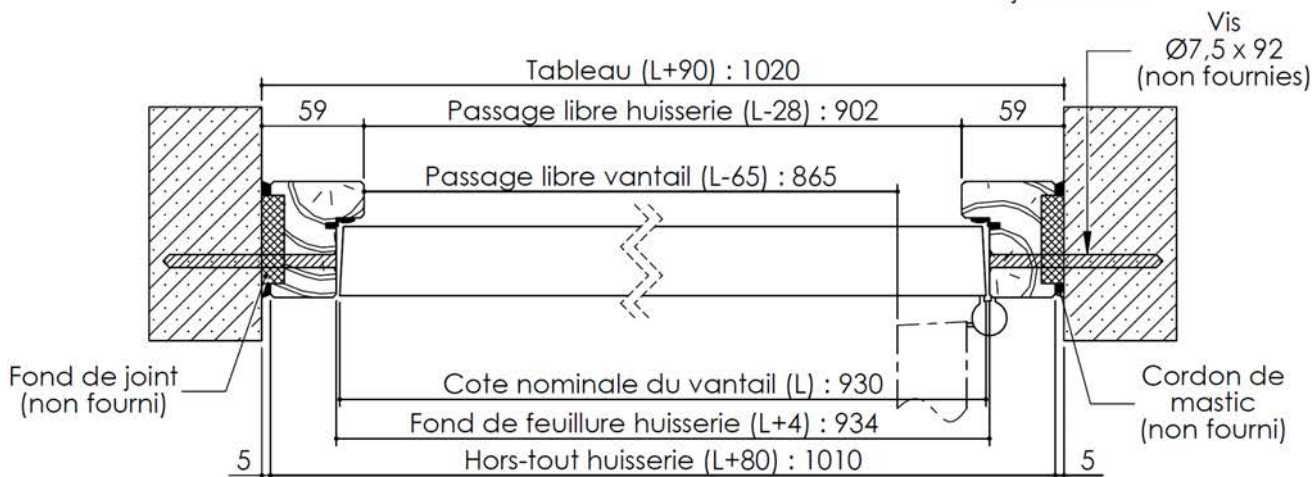
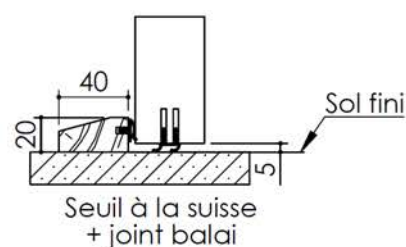
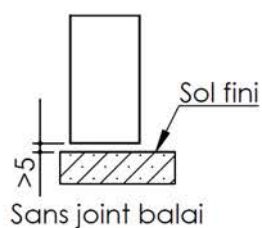
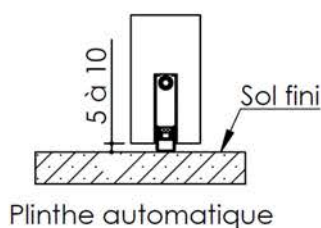

PB-7-1V 01/07/2019

Plan PB-7-2V _ Ind4 : Huisserie bois - Pose en tableau

Gamme Porte de Communication

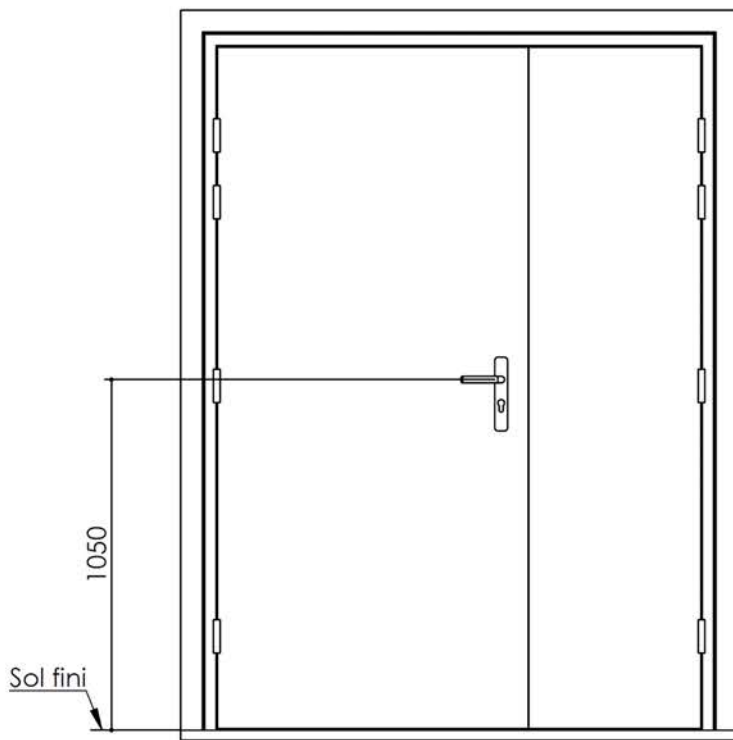

Huisserie non isophonique

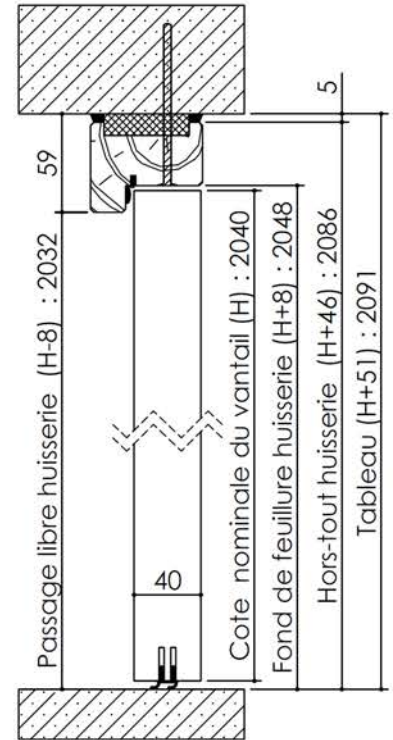
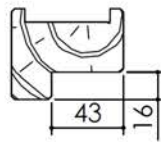

Huisserie isophonique

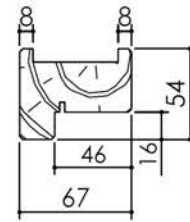

Variantes bas de porte

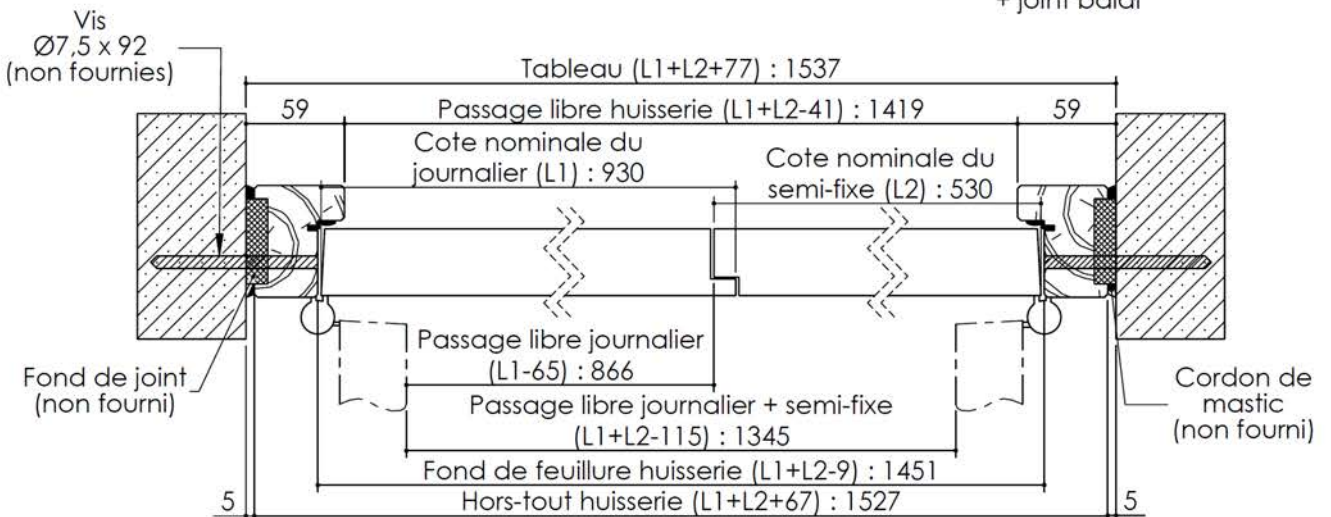
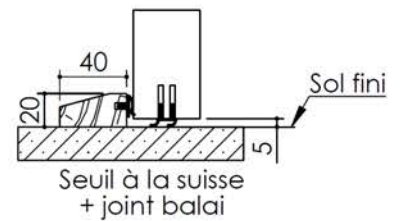
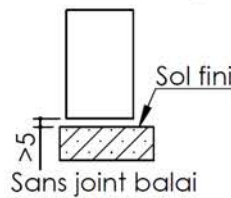
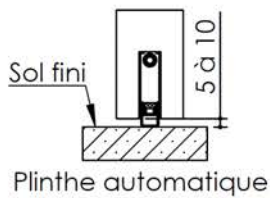

PB-7-2V 01/07/2019

Plan PB-26-1V _ Ind4 : Huisserie bois - Pose en tableau

Gamme Porte de Communication

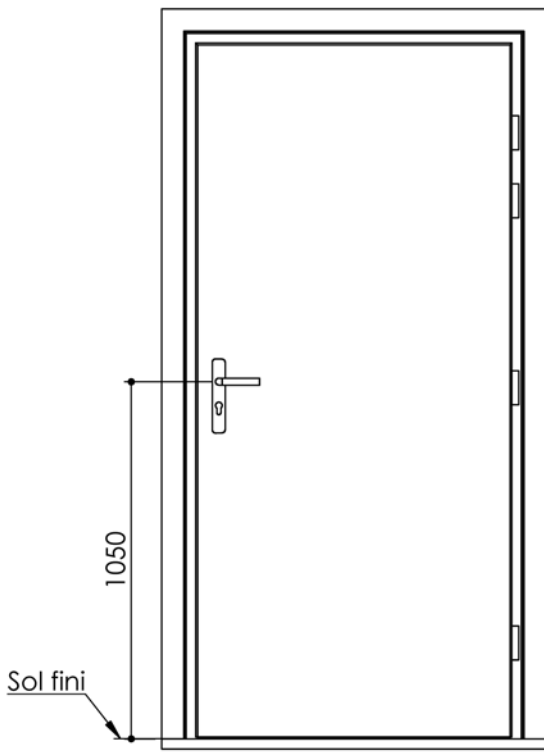

Huisserie non isophonique

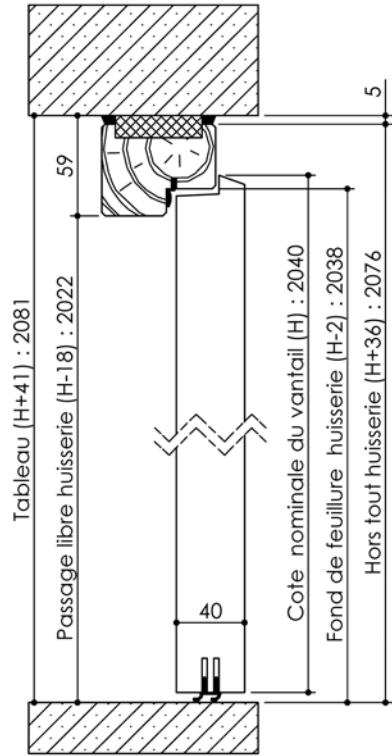

Huisserie isophonique

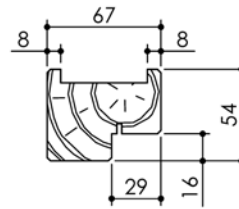
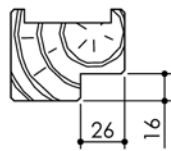

Variantes bas de porte

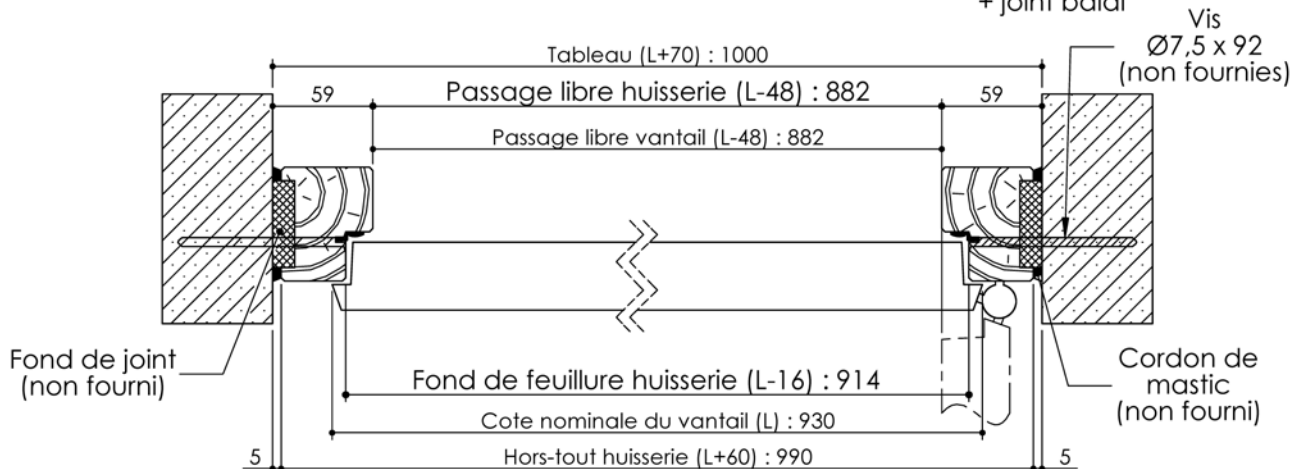
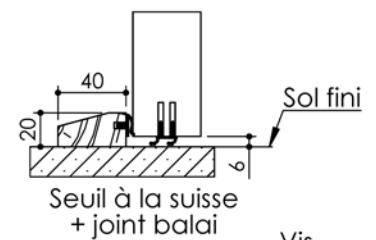
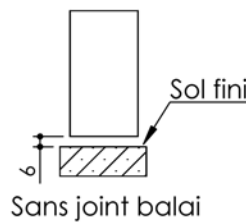
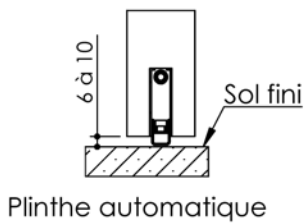

PB-26-1V 26/10/2020

Plan non contractuel, Keyor se réserve le droit de modifier ce plan pour des raisons industrielles

Plan PB-26-2V _ Ind5 : Huisserie bois - Pose en tableau

Gamme Porte de Communication

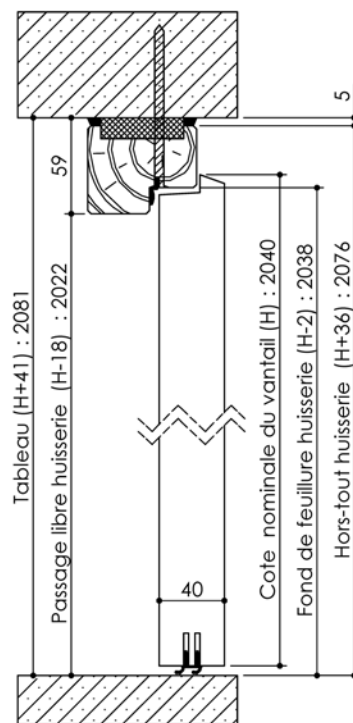
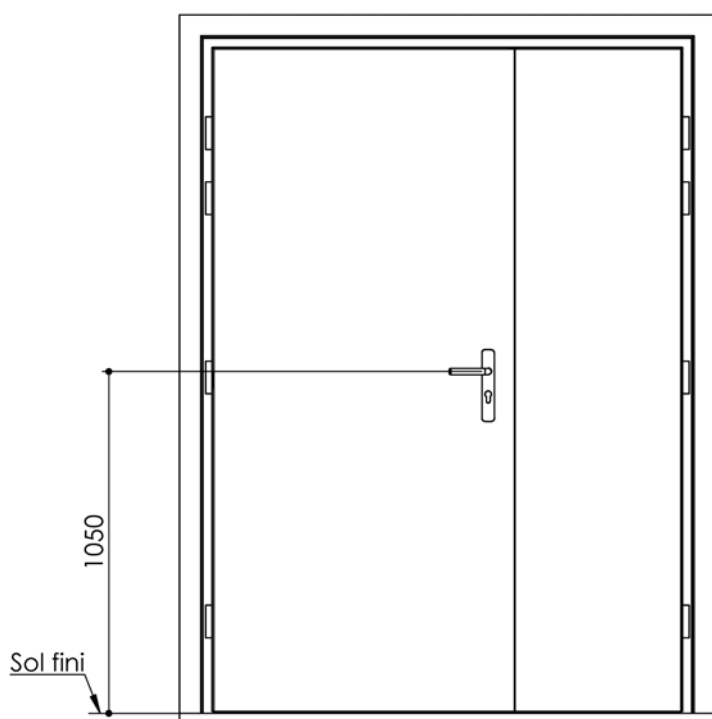

Huisserie non isophonique

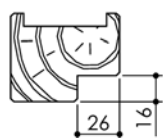

Huisserie isophonique

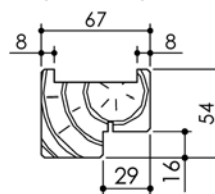

Variantes bas de porte

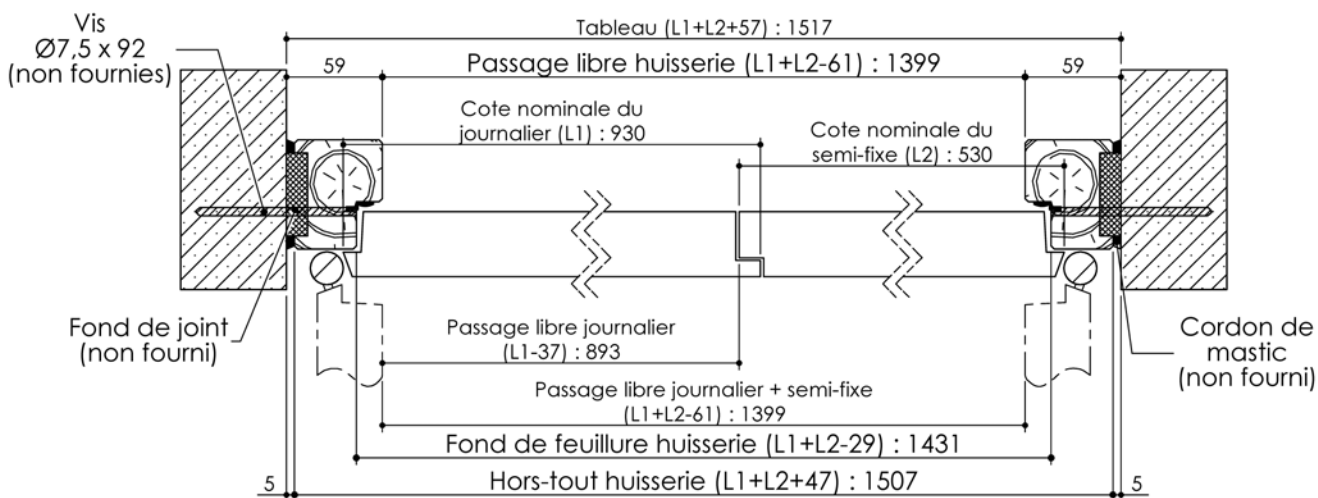
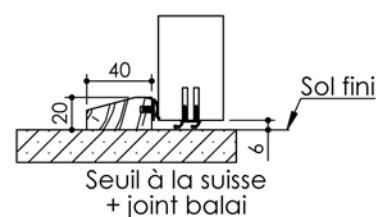
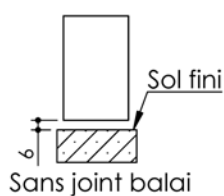
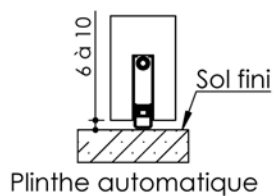

PB-26-2V 26/10/2020

Plan non contractuel, Keyor se réserve le droit de modifier ce plan pour des raisons industrielles