

# Plan PB-220-1V \_ Ind4 : Bati métal -

## Pose scellée

Gamme Porte feu EI60

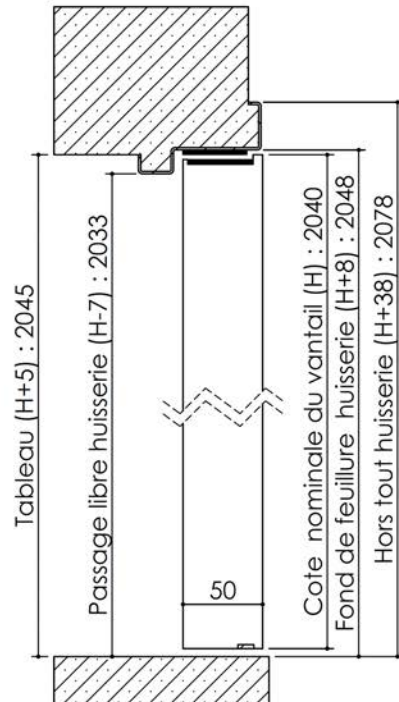
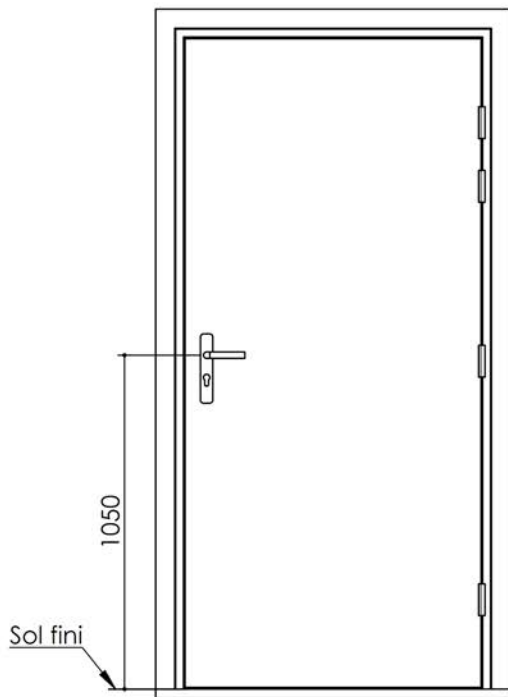

Variante bas de porte

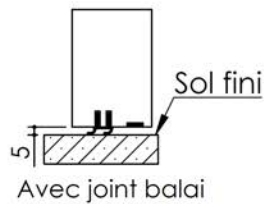

Huisserie non isophonique

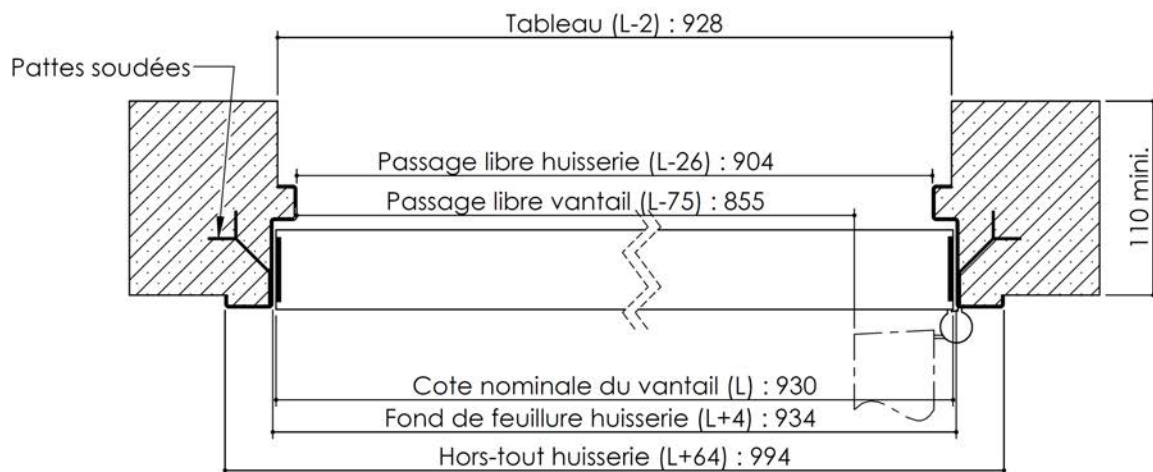
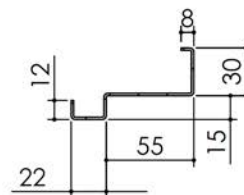

**KEYOR**

PB-220-1V 01/07/2019

Plan non contractuel, Keyor se réserve le droit de modifier ce plan pour des raisons industrielles

# Plan PB-220-2V-A \_ Ind4 : Bati métal - Pose en scellée

Gamme Porte feu EI60 GD (SUPRAFEU GD feuillure centrale de 15).

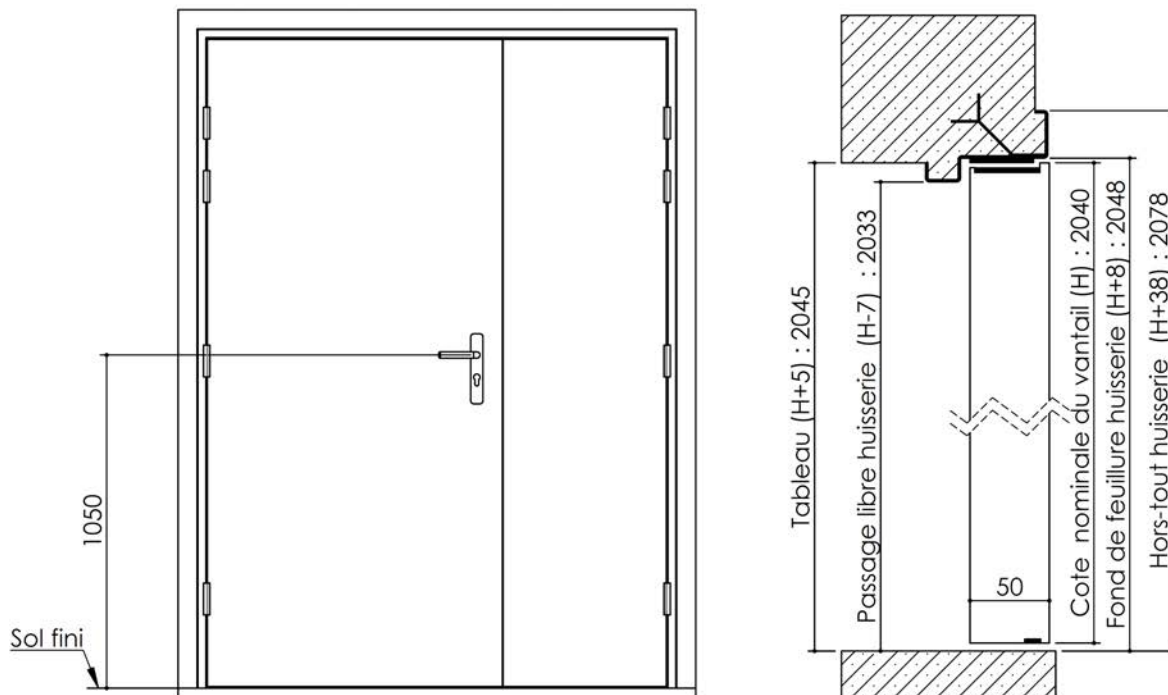

Variante bas de porte

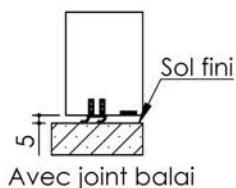

Détail de feuillure centrale de 15

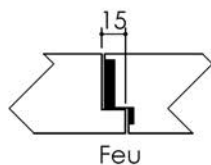

Huisserie non isophonique

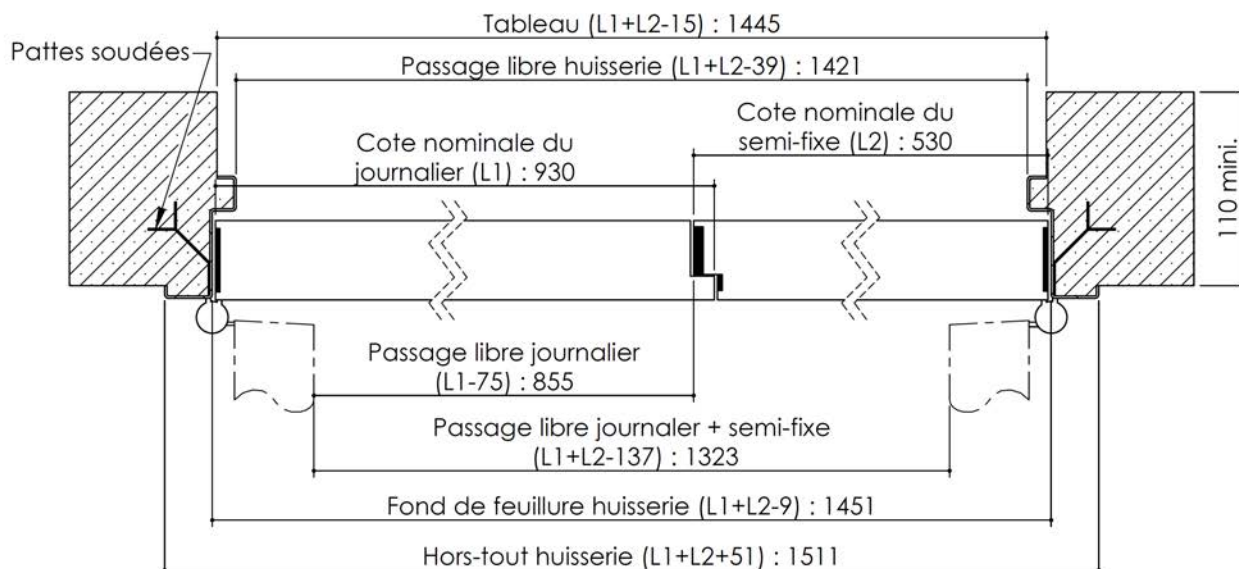
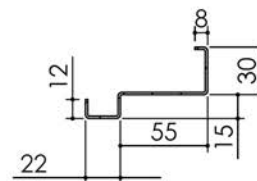

PB-220-2V-A 01/07/2019

# Plan PB-220-2V-B \_ Ind5 : Bati métal - Pose scellée

Gamme Porte feu EI60 STD (SUPRAFEU EI60 feuillure centrale de 25).



Largeur standard en 2V : 935 + 535

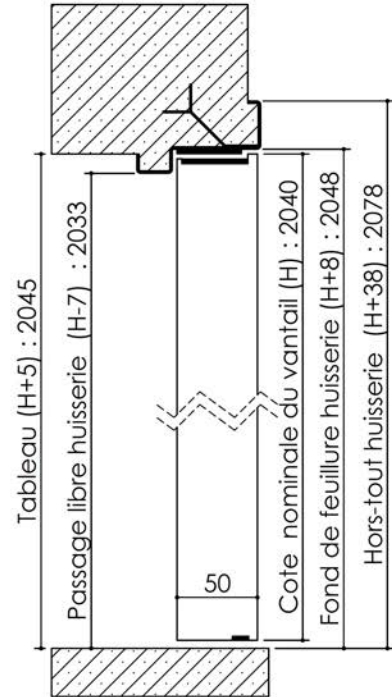
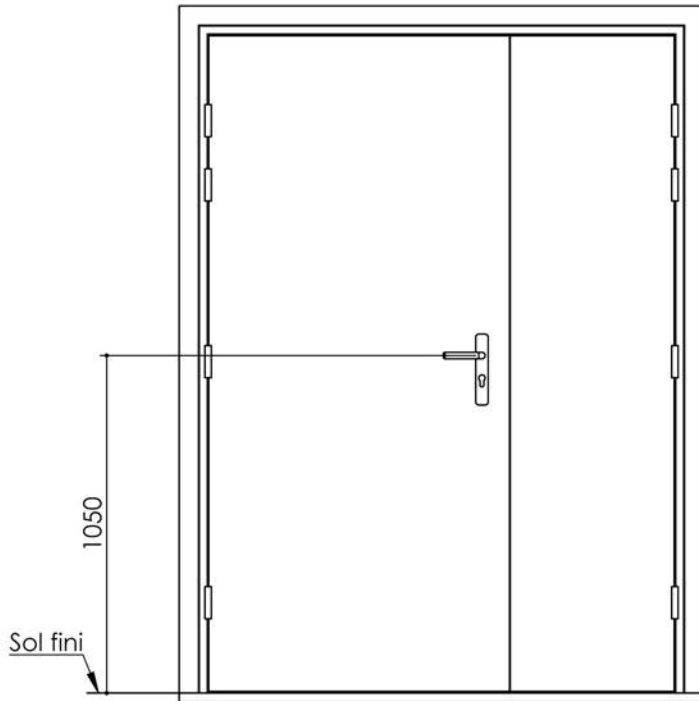

Variante bas de porte

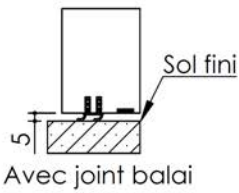

Détail de feuillure centrale de 25

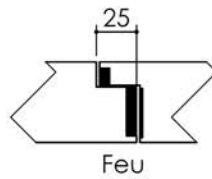

Huisserie non isophonique

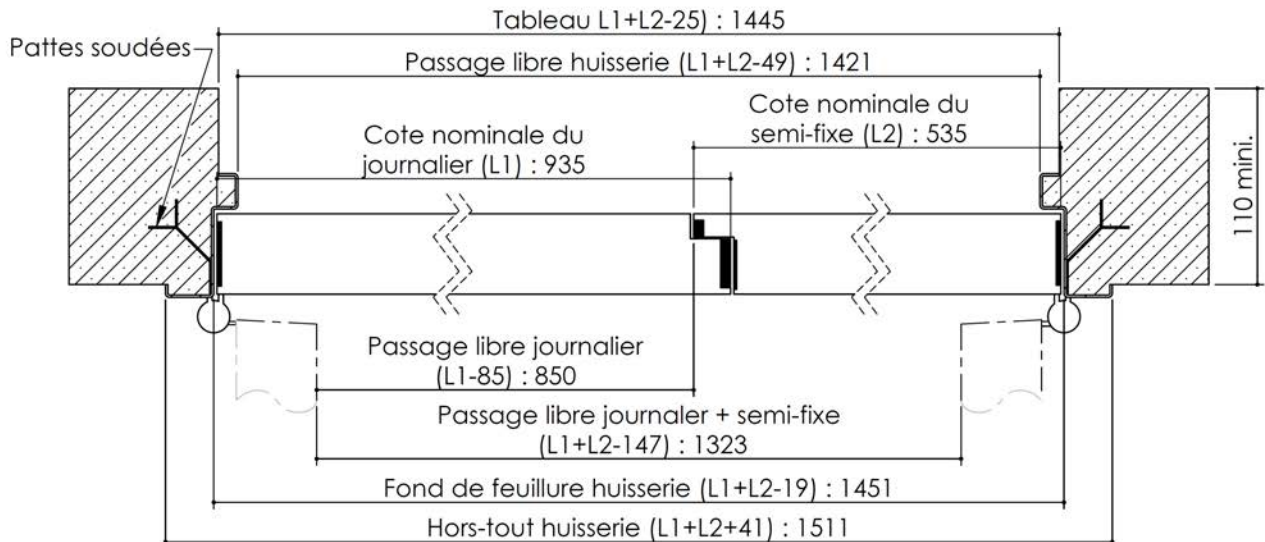
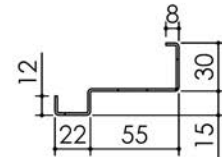

PB-220-2V -B 01/07/2019

Plan non contractuel, Keyor se réserve le droit de modifier ce plan pour des raisons industrielles