

# Plan PB-162-1V \_ Ind2 : Huisserie mixte - Pose en tableau

Gamme Porte feu EI90 Double Action

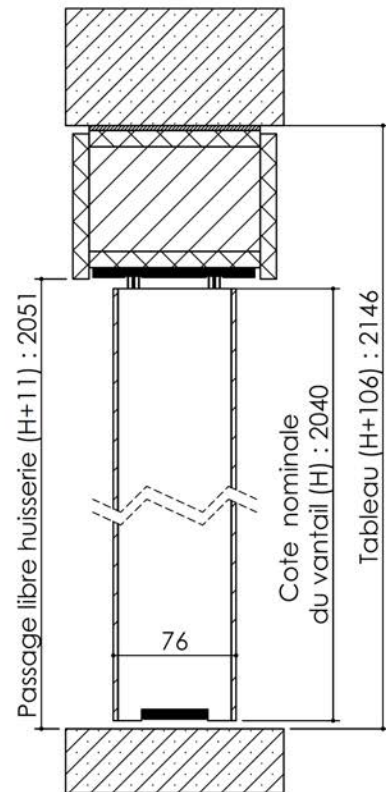

Montant côté battement

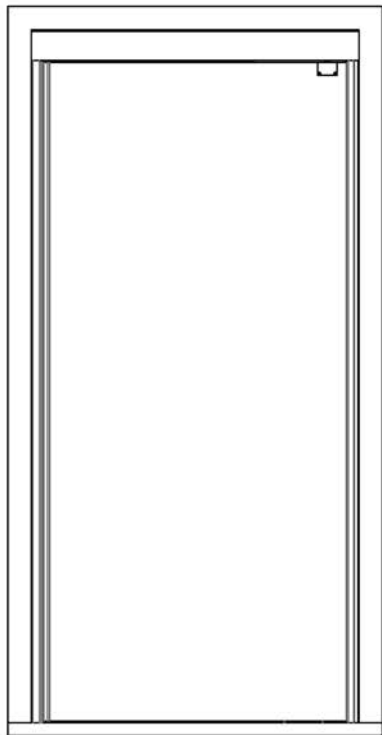
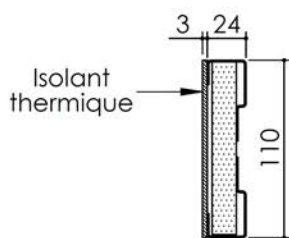

Traverse

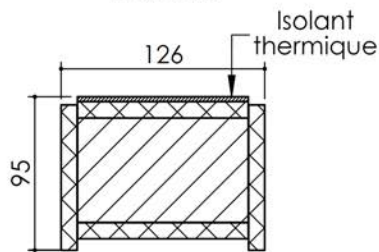

Montant côté articulation

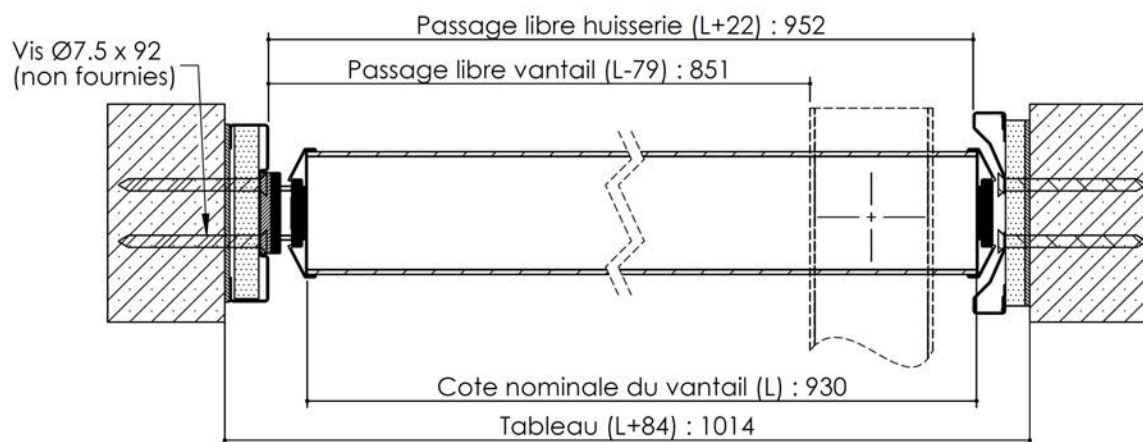
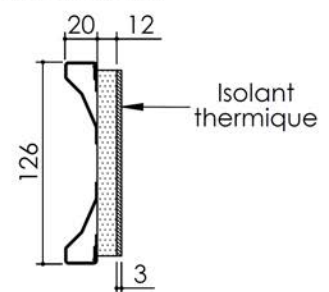

**KEYOR**

PB-162-1V 01/07/2019

Plan non contractuel, Keyor se réserve le droit de modifier ce plan pour des raisons industrielles

# Plan PB-162-2V \_ Ind2 : Huisserie mixte - Pose en tableau

Gamme Porte feu EI90 Double Action

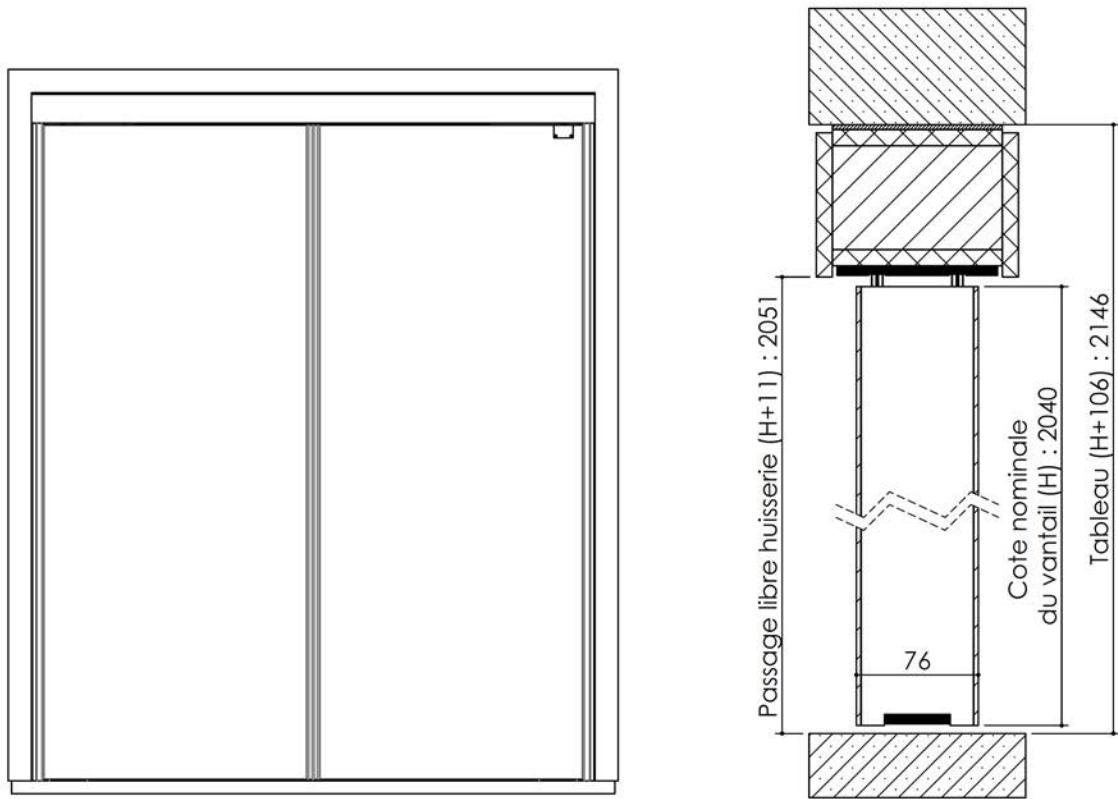

Montant côté articulation

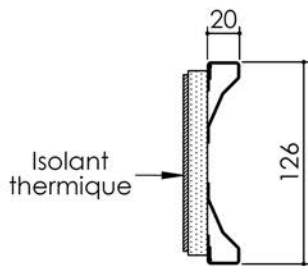

Traverse

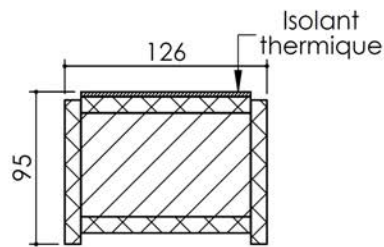

Montant côté articulation

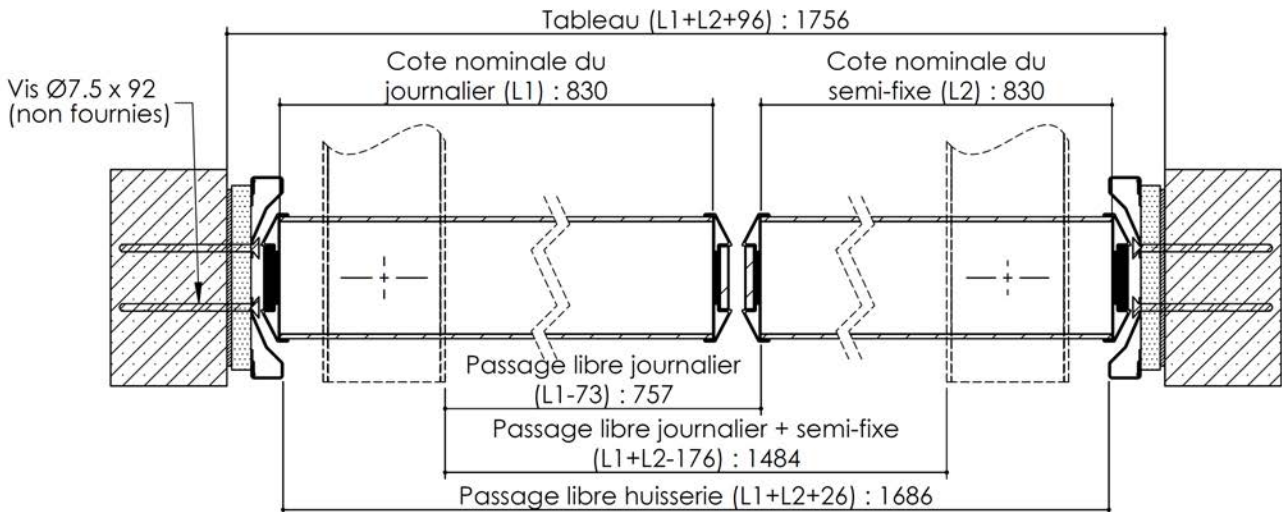
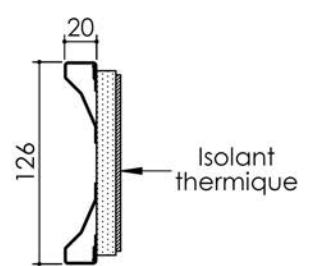

PB-162-2V 01/07/2019