

Plan PM-11 _ ind2 : Huisserie métal - Pose en reprise de doublage interieur (ITI P90) ouverture extérieure

Gamme Pavillon 31, 40

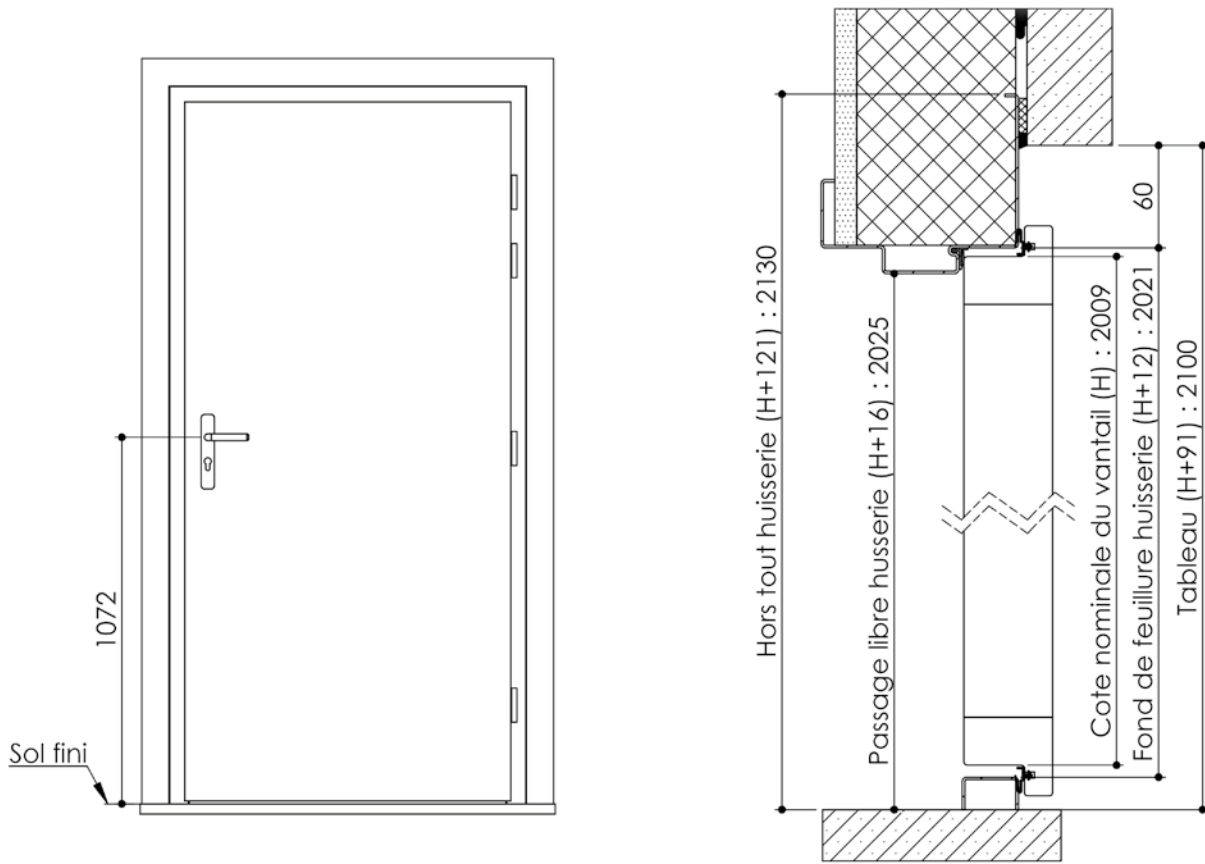

Variantes bas de portes

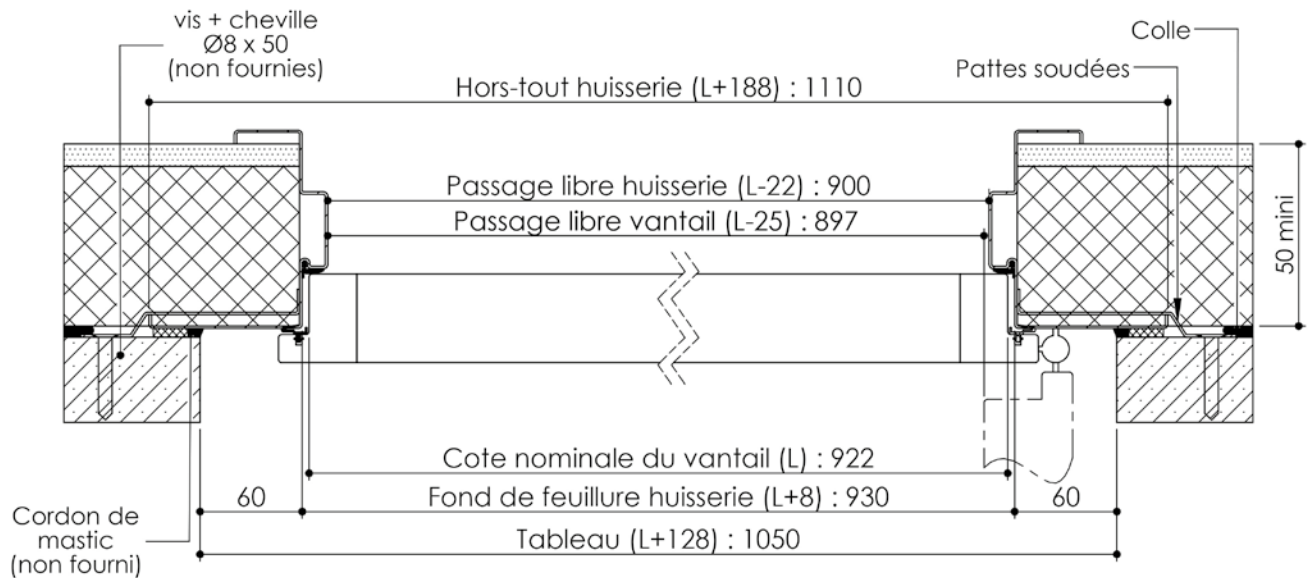
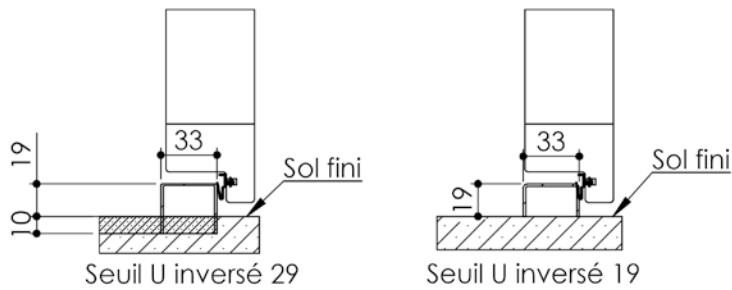

Cahier
technique

Plan PM-11 _ind2 : Huisserie métal - Pose en reprise de doublage intérieur (ITI P90) ouverture extérieure

Gamme Pavillon 31, 40

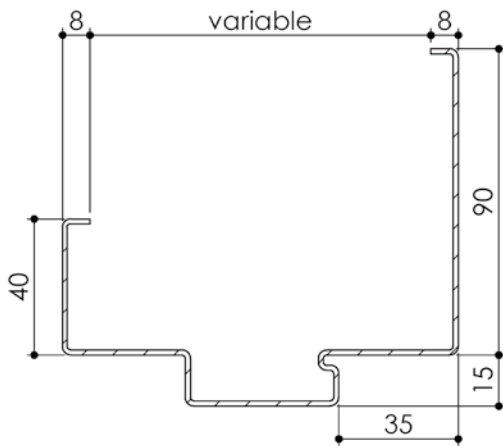
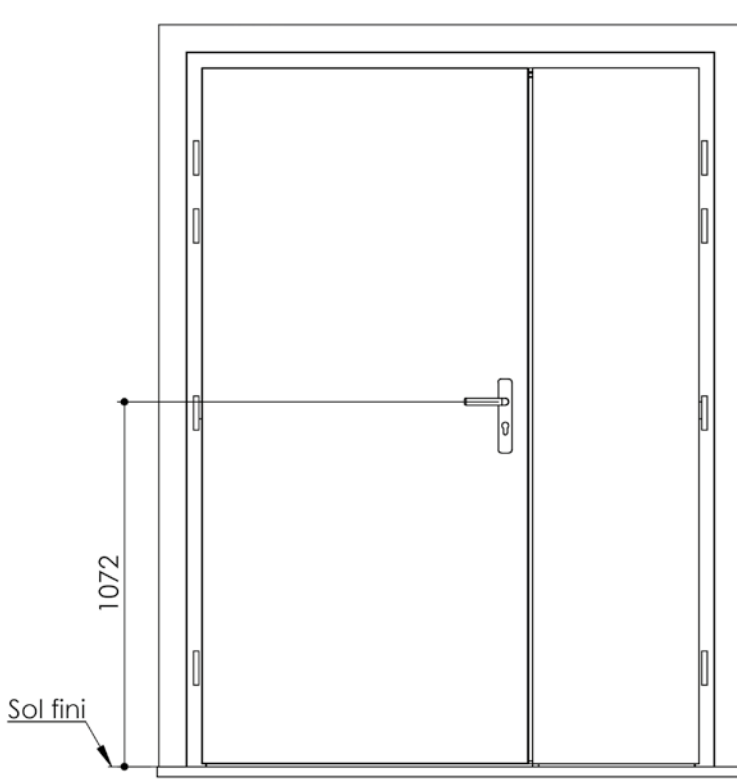

Huisserie isophonique
Pavillon 31, 40

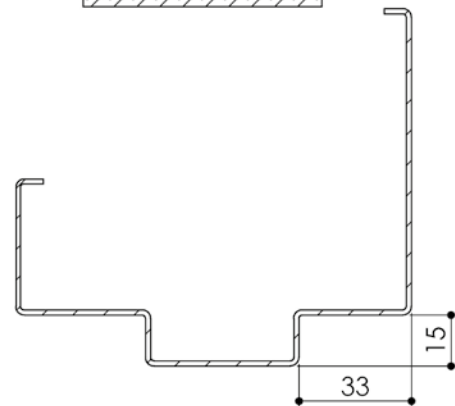
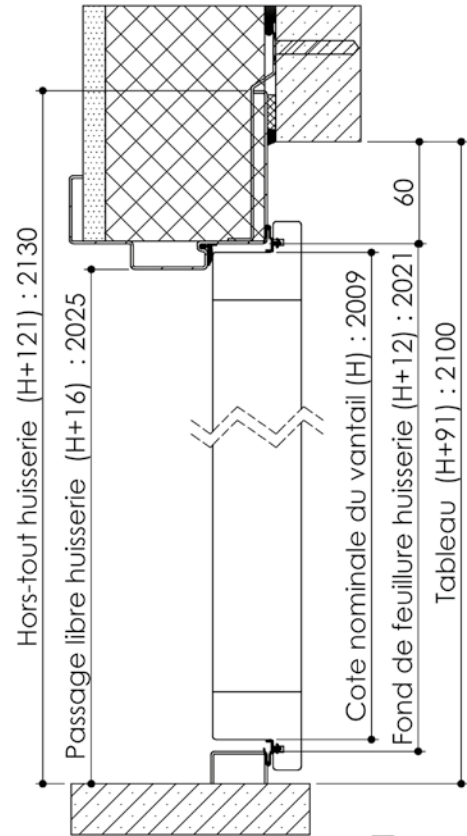

Huisserie non isophonique
Pavillon 31

